

Trolley Parts List

- 1) Tubular Mounting Frame (Gas Bottle) x 1
- 2) Angle Runner (RH) x 1
- 3) Angle Runner (LH) x 1
- 4) Mounting Frame Gusset Plate x 2
- 5) Front Mounting Plate (Castors) x 1
- 6) Support Bracket (Gas Bottle) x 2
- 7) Wheel (Ø250) x 2
- 8) Wheel Axle x 2
- 9) Swivel Castor (Ø100) x 2
- 10) Plastic End Cap (Ø20) x 2
- 11) 25mm x 1560mm Fabric Strap With Buckle x 1
- 12) 25mm x 1130mm Fabric Strap With Buckle x 1
- 13) Retaining Washer (Ø20) x 2
- 14) M8 x 35 Hex Set Screw x 2
- 15) M8 x 16 Hex Set Washer Head Screw x 8
- 16) M6 x 12 Hex Set Washer Head Screw x 12
- 17) M8 Hex Washer Head Nut x 10
- 18) M6 Hex Washer Head Nut x 12
- 19) M20 Flat Washer x 2
- 20) M8 Flat Washer x 2

10



11 & 12

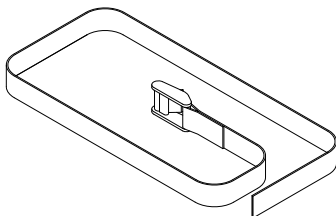

13

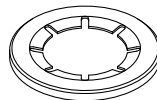

14

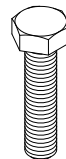

15

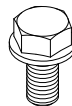

16



17



18



19

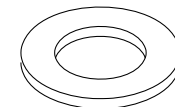

20



FIG 1

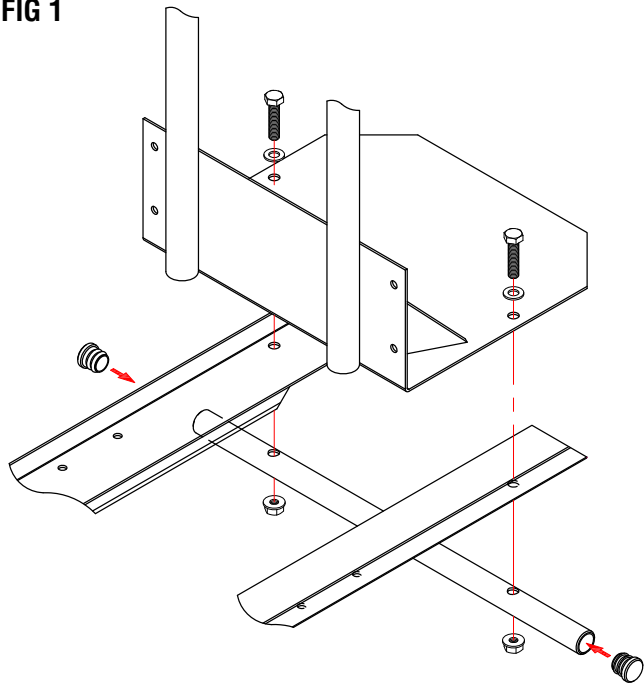

Affix the plastic end caps (10) in the wheel axle ends (8) prior to assembly. Take the tubular mounting frame (1) and the angle runners (2 & 3) along with the wheel axle. Align the mounting holes as shown in FIG 1 and secure using the M8x35 screws (14), flat washers (20) and nuts (17) supplied.

Note: Do not fully tighten the mounting screws until the gusset plates have been assembled (see FIG 5).

FIG 2

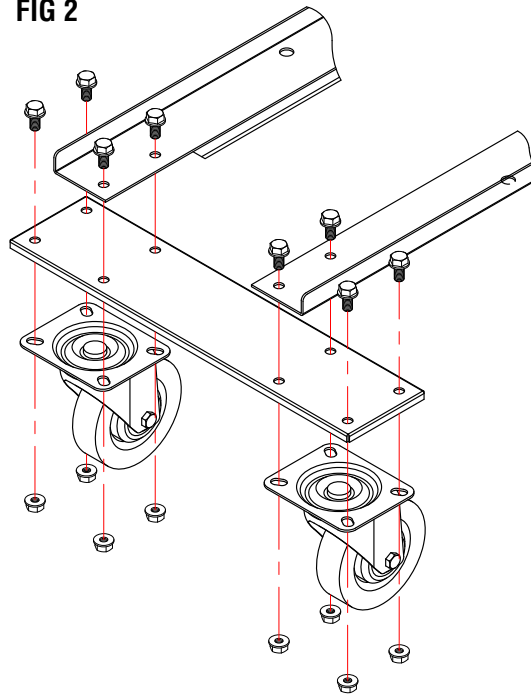

Take the front mounting plate (5) and the swivel castors (9) and assemble with the angle runners. Align the mounting holes as shown in FIG 2 and secure using the M8x16 screws (15) and nuts (17) supplied.

Note: Do not fully tighten the fixing screws until the gusset plates have been assembly (see FIG 5).

FIG 3

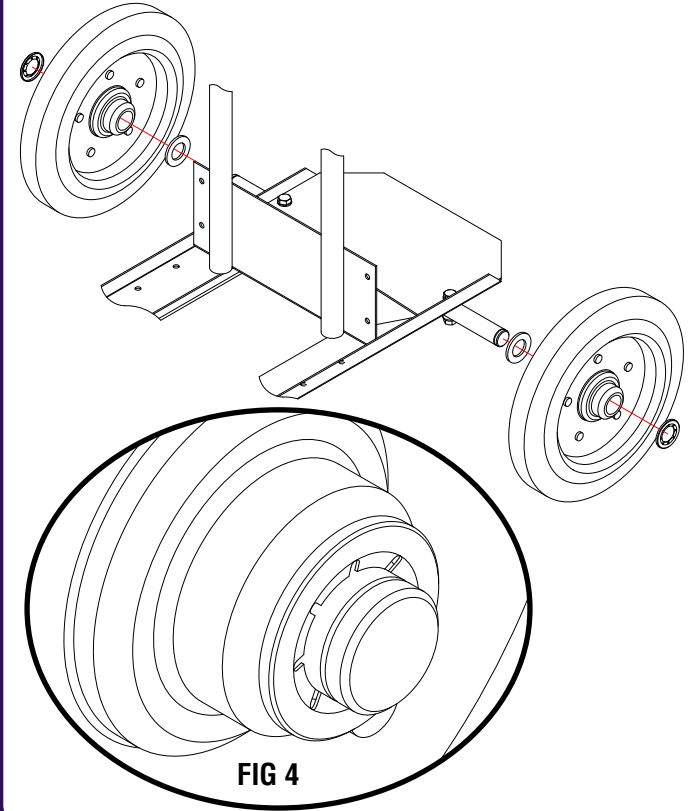

Next assemble the wheels on the axle. First slide the M20 washers (19) on both ends of the axle. Then slide the wheels (7) onto the axle and up to the washers. The retaining washers (13) can then applied to secure the wheels in position. FIG 4 shows the final assembly.

FIG 5

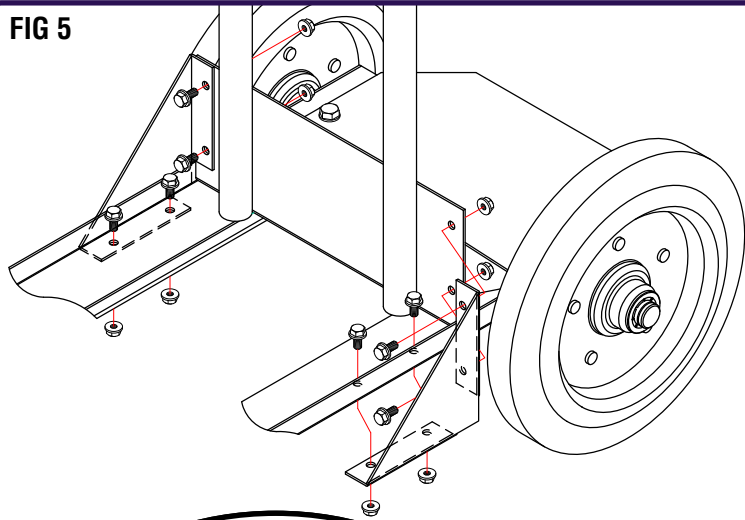
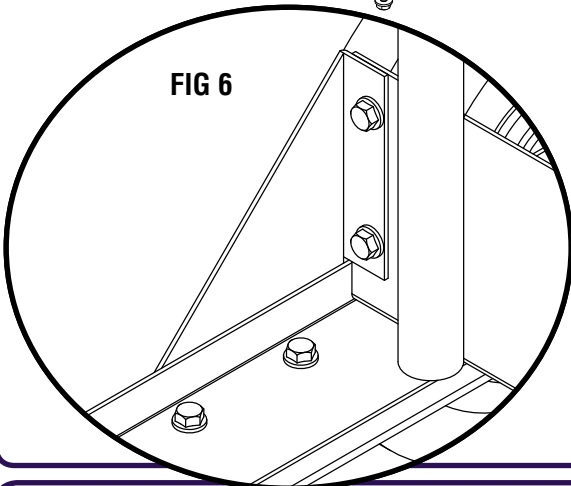

FIG 6



Assemble the gusset plates using the M6x12 screws (16) and nuts (18) as shown in FIG 5. A complete gusset plate assembly should look like FIG 6.

Note: The other fixing screws in FIG 1 & 2 can now be tightened to complete the lower trolley assembly.

FIG 7

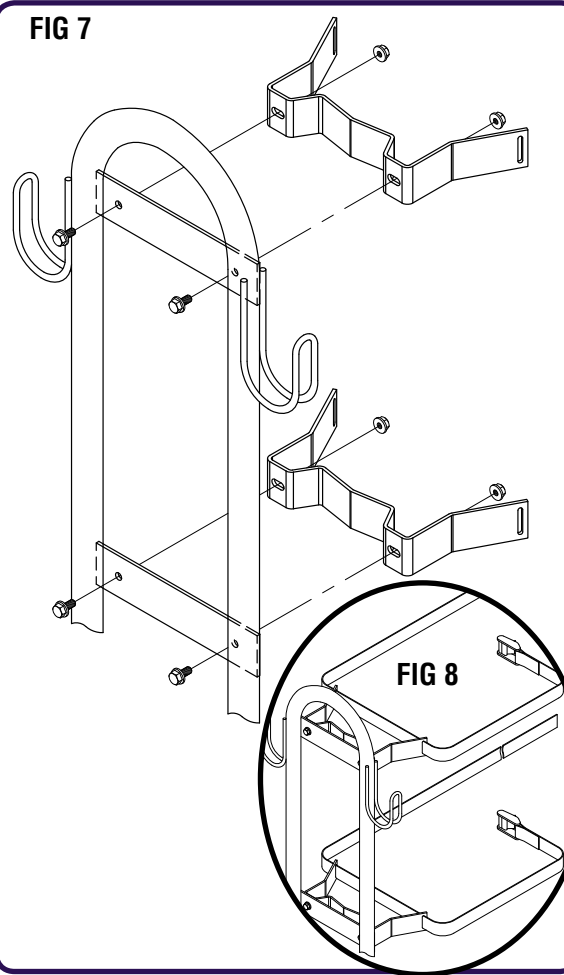
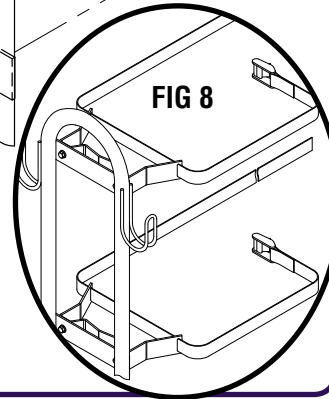
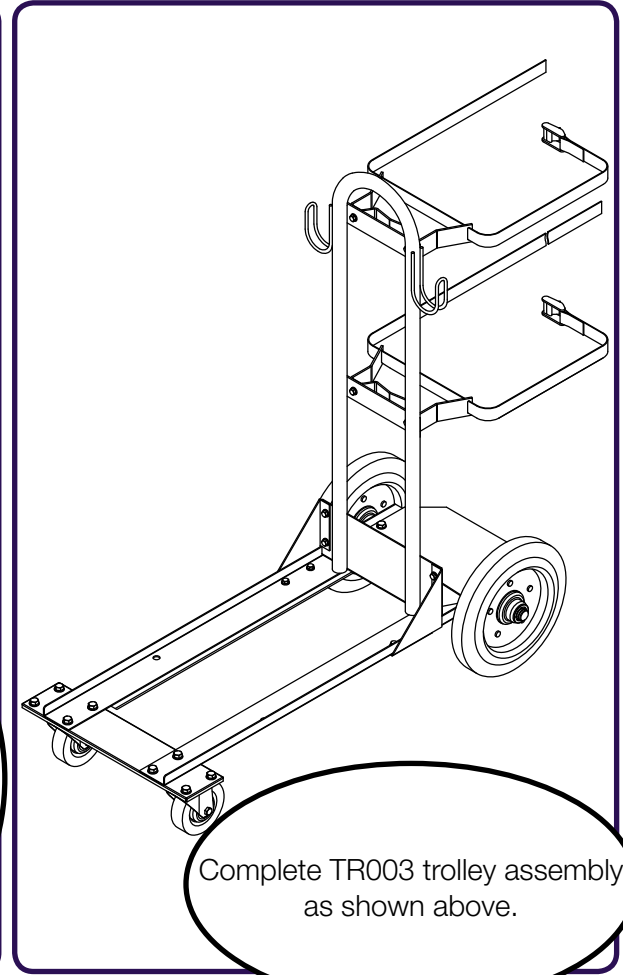

FIG 8



Finally the gas bottle support brackets can be fixed using the remaining M6x12 screws (16) and nuts (18) as shown in FIG 7. The straps (11 & 12) can then be laced through the bracket slots with the longer strap at the bottom (see FIG 8).

Note: The other fixing screws in FIG 1 & 2 can now be tightened to complete the lower trolley assembly.



Complete TR003 trolley assembly as shown above.

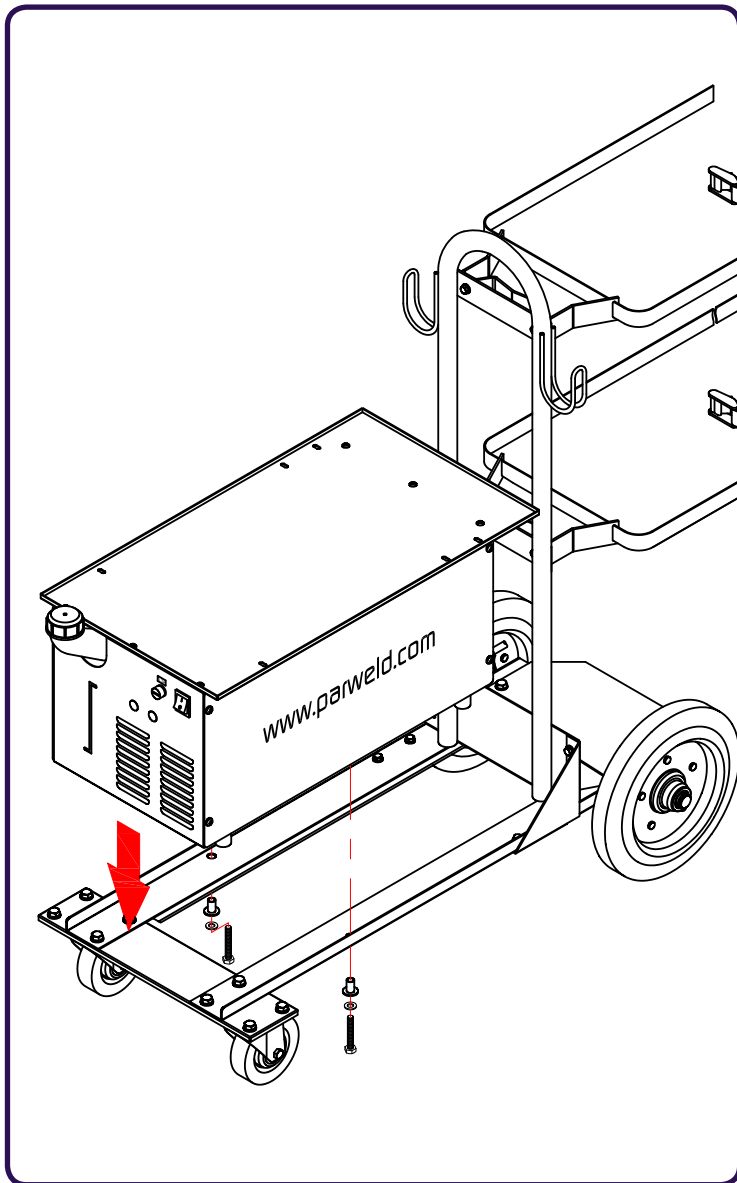

Place the XTS904-905 on the base of the trolley and fix using 2 bolts and spacers passed up through the trolley into the threaded holes in the water cooler .

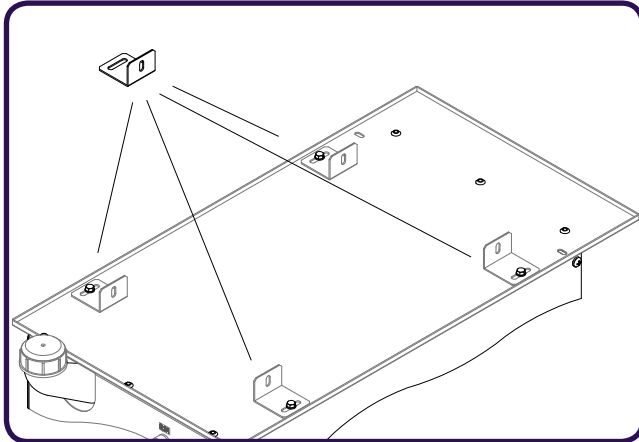

For XTT202 AC/DC use angle bracket x4 and fix to water cooler top plate

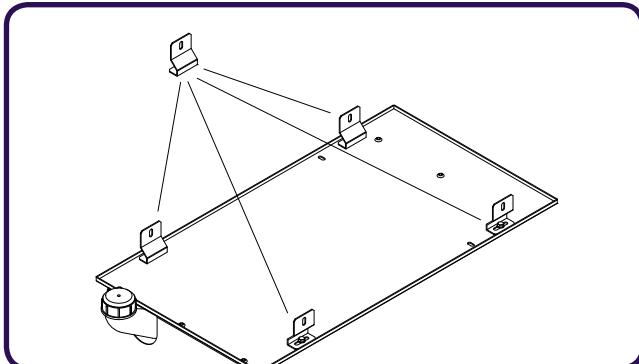

For XTT353 AC/DC use double bend bracket x4 and fix to water cooler top plate

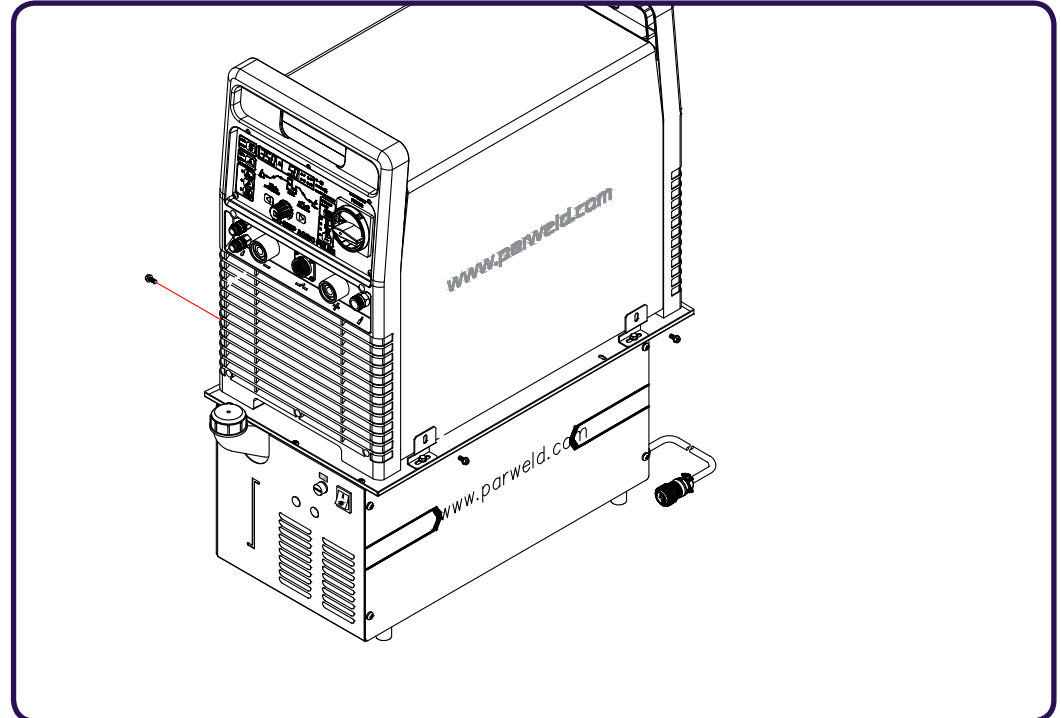

Remove 4 screws from side of machine panel,
Place machine on top of cooler and align with angle brackets
Fix machine to the angle bracket with original screws